

| REVISIONS |   |                       |                      |
|-----------|---|-----------------------|----------------------|
| REV       | DESCRIPTION   | DATE                  | APPROVED             |
| C         | REACTIVATED AS PER REV "A" TO SHOW AEROQUIP DESIGN  | 2006-05-16<br>RHJ/KBM | EN-F30034<br>DP-1299 |
| D         | ADDED MARKING FOR CRIMPING LOCATION. UPDATED DRAWING ACCORDINGLY.<br>1) ADDED NOTE #4<br>2) ADDED DIMENSION.<br>3) WAS Ø12.7 [.50] REF HOLE<br>4) FINISH WAS "ZINC PLATE PER ACES 2751" | 2021-11-16<br>DMK/ARK | CO-0221288           |

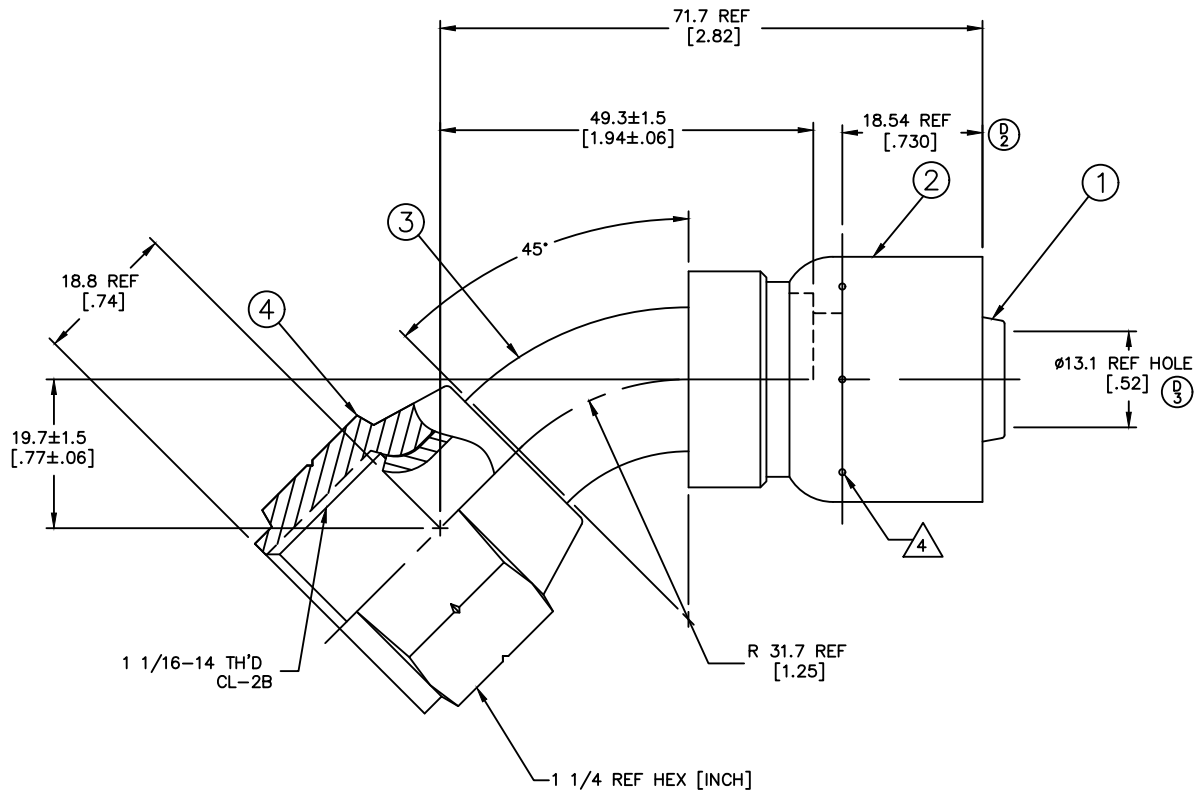

METRIC

4. CRIMP LOCATION IMPRESSION MARK (6-8 PLACES). 9

3. CAN BE MADE FROM TUBING FROM SPECIFICATIONS ON ELBOW DRAWING.

2. DIMENSIONS ARE IN MILLIMETERS [INCHES].

1. PROCESS AS FOLLOWS:

- (a) BRAZE PER ACES 67P3 OR P26. D
- (b) ZINC PLATE PER ES 2751D8. 4
- (c) ASSEMBLE NUT AND FLARE PER FF481.
- (d) ASSEMBLE SOCKET PER ES 2409P17.

|              |              |            |            |            |  |
|--------------|--------------|------------|------------|------------|--|
| FJ3246-1212S | FW1314-1212S | FW1186-12S | 404501-12S | 210222-12S |  |
| PART NUMBER  | 1 NIPPLE     | 2 SOCKET   | 3 ELBOW    | 4 NUT      |  |

| LIST OF MATERIALS |          | DRAWN                  |                     | FLUID CONVEYANCE DIVISION |         |
|-------------------|----------|------------------------|---------------------|---------------------------|---------|
| ITEM NO.          | MATERIAL | S. BOHN                |                     |                           |         |
| 1                 | STEEL    | CHECKED                |                     |                           |         |
| 2                 | STEEL    | R. D. WEBB             |                     |                           |         |
| 3                 | STEEL    | I. G. CLARK            |                     |                           |         |
| 4                 | STEEL    | APPROVED               | DRAWING TITLE       |                           |         |
|                   |          | RELEASE DATE           | FITTING ASSEMBLY    |                           |         |
|                   |          | 2001-01-16             | 45°, SAE 45° SWIVEL |                           |         |
|                   |          | EN-F20803              | 1503 HOSE           |                           |         |
|                   |          | DP-1290                | SIZE                | DRAWING NUMBER            | REV     |
|                   |          | THIRD ANGLE PROJECTION | A2                  | FJ3246-1212S              | D       |
|                   |          | SCALE 2/1              | DIST U              | CAGE CODE 01276           | SHEET 1 |

THE REPRODUCTION, DISTRIBUTION AND UTILIZATION OF THIS DOCUMENT AS WELL AS THE COMMUNICATION OF ITS CONTENTS TO OTHERS WITHOUT EXPLICIT AUTHORIZATION IS PROHIBITED. OFFENDERS WILL BE HELD LIABLE FOR THE PAYMENT OF DAMAGES. ALL RIGHT RESERVED IN THE EVENT OF THE GRANT OF A PATENT, UTILITY MODEL OR DESIGN. (PER ISO 16016)