

PART NUMBER	WEATHERHEAD CATALOG NUMBER	TH'D "P"	TH'D "T"	A REF	B REF	C REF	D REF	E REF	F REF
2000-2-4B	48X4	1/8-27	7/16-20	26.9 [1.06]	12.7 [.50]	10.2 [.40]	4.8 [.19]	5.6 [.22]	7/16
2000-2-5B	48X5	1/8-27	1/2-20	29.5 [1.16]	14.2 [.56]	10.2 [.40]	5.6 [.22]	5.6 [.22]	1/2
2000-2-6B	48X6X2	1/8-27	5/8-18	31.8 [1.25]	15.7 [.62]	10.2 [.40]	7.1 [.28]	5.6 [.22]	5/8
2000-4-4B	48X4X4	1/4-18	7/16-20	31.8 [1.25]	12.7 [.50]	14.7 [.58]	4.8 [.19]	7.9 [.31]	9/16
2000-4-5B	48X5X4	1/4-18	1/2-20	34 [1.34]	14.2 [.56]	14.7 [.58]	5.6 [.22]	7.9 [.31]	9/16
2000-4-6B	48X6	1/4-18	5/8-18	36.6 [1.44]	15.7 [.62]	14.7 [.58]	7.1 [.28]	7.1 [.28]	5/8
2000-4-8B	48X8X4	1/4-18	3/4-16	41.1 [1.62]	19.1 [.75]	14.7 [.58]	10.4 [.41]	7.9 [.31]	3/4
2000-4-10B	-	1/4-18	7/8-14	46 [1.81]	22.4 [.88]	14.7 [.58]	12.7 [.50]	7.9 [.31]	7/8
2000-6-4B	48X4X6	3/8-18	7/16-20	33.3 [1.31]	12.7 [.50]	14.7 [.58]	4.8 [.19]	10.4 [.41]	11/16
2000-6-5B	48X5X6	3/8-18	1/2-20	35.1 [1.38]	14.2 [.56]	14.7 [.58]	5.6 [.22]	10.4 [.41]	11/16
2000-6-6B	48X6X6	3/8-18	5/8-18	36.6 [1.44]	15.7 [.62]	14.7 [.58]	7.1 [.28]	10.4 [.41]	11/16
2000-6-8B	48X8	3/8-18	3/4-16	41.1 [1.62]	19.1 [.75]	14.7 [.58]	10.4 [.41]	10.4 [.41]	3/4
2000-6-10B	48X10X6	3/8-18	7/8-14	46 [1.81]	22.4 [.88]	14.7 [.58]	12.7 [.50]	10.4 [.41]	7/8
2000-8-4B	48X4X8	1/2-14	7/16-20	39.6 [1.56]	12.7 [.50]	19.3 [.76]	4.8 [.19]	14.2 [.56]	7/8
2000-8-6B	48X6X8	1/2-14	5/8-18	42.9 [1.69]	15.7 [.62]	19.3 [.76]	7.1 [.28]	14.2 [.56]	7/8
2000-8-8B	48X8X8	1/2-14	3/4-16	46 [1.81]	19.1 [.75]	19.3 [.76]	10.4 [.41]	14.2 [.56]	7/8
2000-8-10B	48X10	1/2-14	7/8-14	50.8 [2.00]	22.4 [.88]	19.3 [.76]	12.7 [.50]	12.7 [.50]	7/8
2000-8-12B	48X12	1/2-14	1 1/16-14	55.6 [2.19]	25.4 [1.00]	19.3 [.76]	14.2 [.56]	14.2 [.56]	1 1/16
2000-12-8B	48X8X12	3/4-14	3/4-16	49.3 [1.94]	19.1 [.75]	19.3 [.76]	10.4 [.41]	19.1 [.75]	1 1/16
2000-12-10B	48X10X12	3/4-14	7/8-14	52.3 [2.06]	22.4 [.88]	19.3 [.76]	12.7 [.50]	19.1 [.75]	1 1/16
2000-12-12B	48X12X12	3/4-14	1 1/16-14	55.6 [2.19]	25.4 [1.00]	19.3 [.76]	16.0 [.63]	19.1 [.75]	1 1/16
2000-2-2B	48X2	1/8-27	5/16-24	22.9 [.90]	9.7 [.38]	10.2 [.40]	2 [.08]	5.6 [.22]	7/16
2000-2-3B	48X3	1/8-27	3/8-24	25.4 [1.00]	11.2 [.44]	10.2 [.40]	3.3 [.13]	5.6 [.22]	7/16
2000-4-7B	48X7	1/4-18	11/16-16	38.9 [1.53]	17.5 [.69]	14.7 [.58]	7.9 [.31]	7.9 [.31]	11/16

AL 2
AM 1
AM 1
AM 1
AM 1
AM 1
AM 1
AL 1
AL 1
AL 1

REVISIONS			
REV	DESCRIPTION	DATE	APPROVED
AL	REDRAWN. (1) ADDED PART # 2000-2-2B, 2000-2-3B, 2000-4-7B. (2) ADDED WEATHERHEAD CATALOG NUMBER.	2011-07-12 PSW/VJS	0057638-ECO
AM	(1) ADDED WEATHERHEAD CATALOG NUMBER.	2012-04-04 ONJ/PSW	0068739-ECO

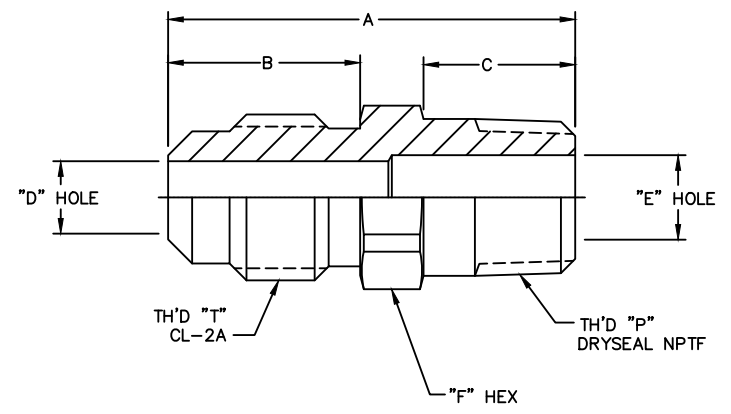

2. MATERIAL: BRASS
1. DIMENSIONS ARE IN MILLIMETERS [INCHES].

METRIC

DRAWN P. WARUDKAR	FLUID CONVEYANCE DIVISION		
CHECKED V. SURYAWANSHI	DRAWING TITLE		
APPROVED Y. KULKARNI	ADAPTER		
RELEASE DATE 2011-07-12	SAE 45° FLARE - CONNECTOR		
0057638-ECO	(SAE #010102)		
THIRD ANGLE PROJECTION	SIZE A2	DRAWING NUMBER 2000-B	REV AM
SCALE NONE	DIST U	CAGE CODE 01276	SHEET 1
THE REPRODUCTION, DISTRIBUTION AND UTILIZATION OF THIS DOCUMENT AS WELL AS THE COMMUNICATION OF ITS CONTENTS TO OTHERS WITHOUT EXPLICIT AUTHORIZATION IS PROHIBITED. OFFENDERS WILL BE HELD LIABLE FOR THE PAYMENT OF DAMAGES. ALL RIGHT RESERVED IN THE EVENT OF THE GRANT OF A PATENT, UTILITY MODEL OR DESIGN. (PER ISO 16016)			

REV. AM
SH. 1
2000-B
DWG. NO.