

REVISIONS			
REV	DESCRIPTION	DATE	APPROVED
G	REDRAWN - SUPERSEDES 1SA_FRB_SHEET 3 REV."F" FOR 1SA8FRB8	11-3-95	EN-F16053 DP-24900
H	1) FINISH WAS ZINC PLATE PER ACES 2751*.	2020-07-20 ASB	CO-0206072

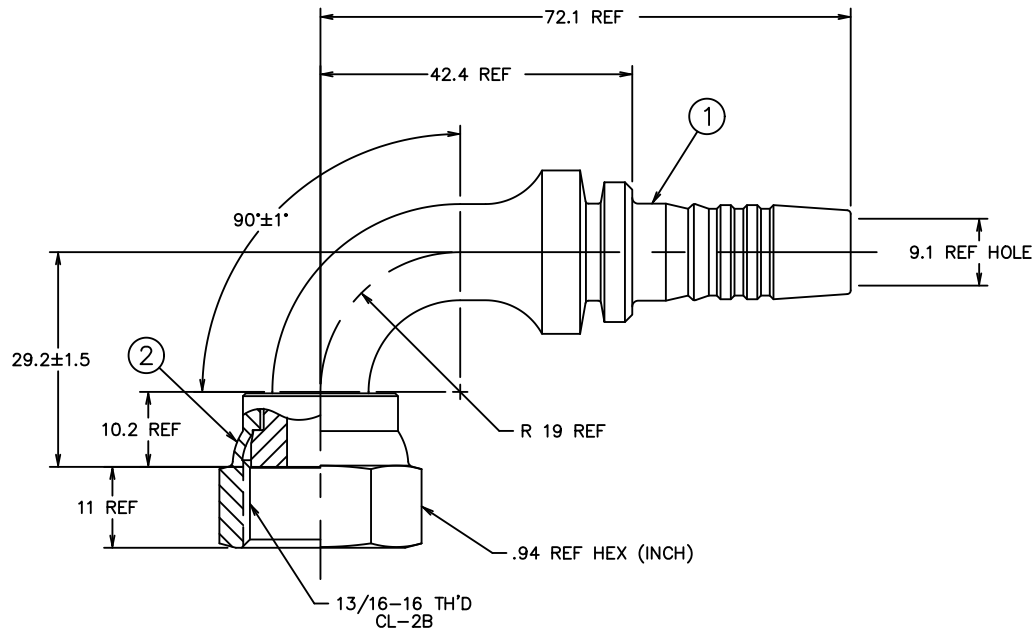

72.1	2.84
42.4	1.67
29.2±1.5	1.15±.06
19	.75
11	.43
10.2	.40
9.1	.36
MM	INCH

CONVERSION

METRIC

1. PROCESS AS FOLLOWS:
 (a) BEND NIPPLE TO DIMENSIONS SHOWN.
 (b) ZINC PLATE PER ES 2751D8.
 (c) CRIMP NUT PER ACES 2409P1. H
1

1SA8FRB8	1F40023-0808AB	FC1473-08S		
AEROQUIP PART NUMBER	1 NIPPLE	2 NUT		
LIST OF MATERIALS				
ITEM NO.	MATERIAL	DRAWN R.D. GARRETT	FLUID CONVEYANCE DIVISION DRAWING TITLE NIPPLE ASSEMBLY 90°, ORS FEMALE SWIVEL, 2781 HOSE	
1	STEEL	CHECKED M. MOLINA		
2	STEEL	APPROVED R.D. GARRETT		
		RELEASE DATE 1995-11-07		
		EN-F16053	SIZE A3	DRAWING NUMBER 1SA8FRB8
		DP-24900	THIRD ANGLE PROJECTION	REV H
			SCALE 2/1	DIST U
			CAGE CODE 01276	SHEET
THE REPRODUCTION, DISTRIBUTION AND UTILIZATION OF THIS DOCUMENT AS WELL AS THE COMMUNICATION OF ITS CONTENTS TO OTHERS WITHOUT EXPLICIT AUTHORIZATION IS PROHIBITED. OFFENDERS WILL BE HELD LIABLE FOR THE PAYMENT OF DAMAGES. ALL RIGHT RESERVED IN THE EVENT OF THE GRANT OF A PATENT, UTILITY MODEL OR DESIGN. (PER ISO 18016)				