

REVISIONS			
REV	DESCRIPTION	DATE	APPROVED
L	REDRAWN. UPDATED TO DANFOSS FORMAT AND DIMENSION STYLE. 1) ADDED PART #ISA6FRB6TZ.	2014-06-09 JJS/VSP	0098514-ECO RPS 38363
M	1) WAS, "ZINC PLATE PER ES 2751"	2020-07-21 PAI	CO-0206167

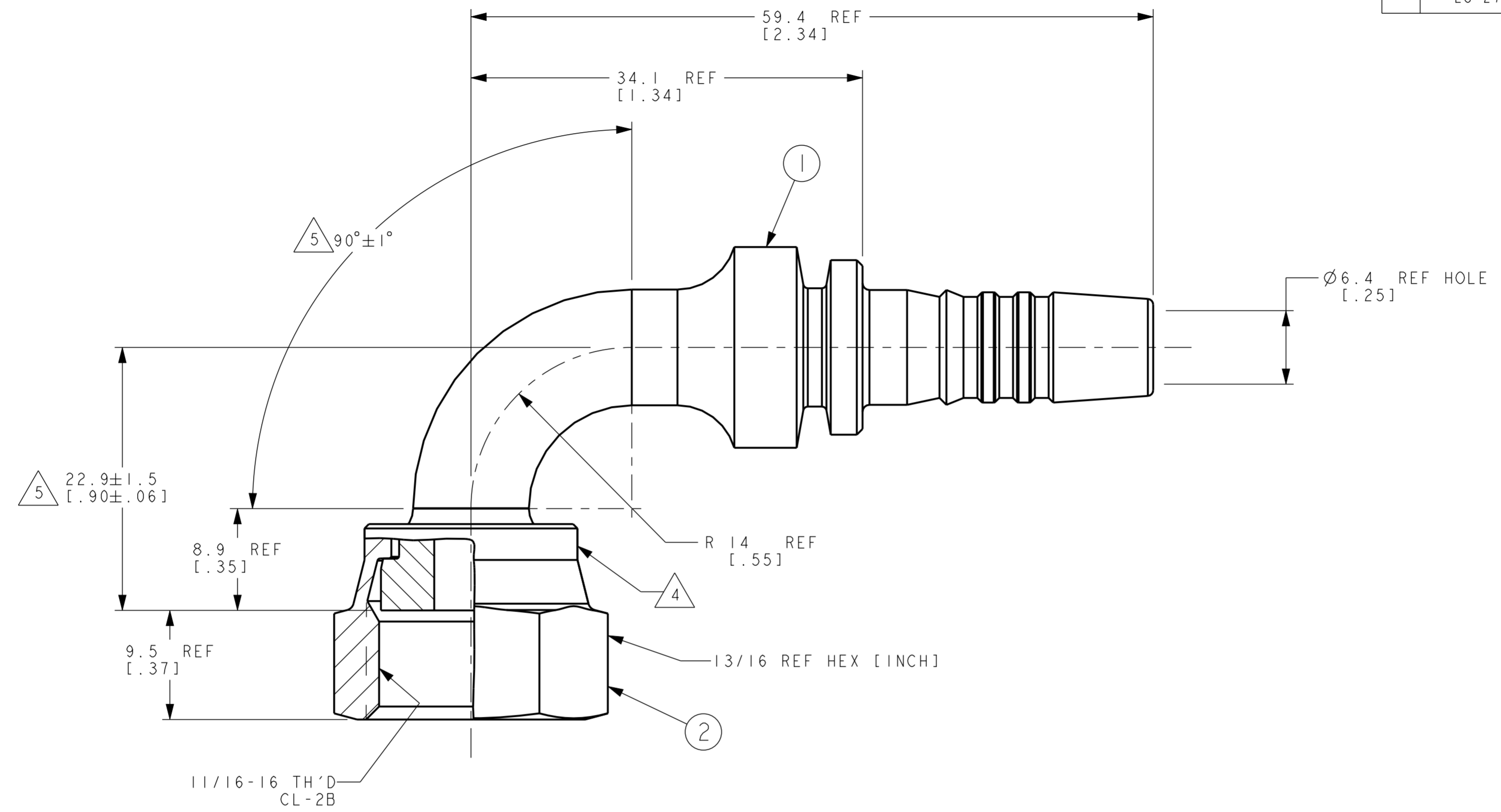

METRIC

④	⑤	ISA6FRB6TZ	IF40048-0606TZ	FCI473-06-503		
②	③	ISA6FRB6	IF40023-0606AB	FCI473-06S		
PART NUMBER		① NIPPLE	② NUT			

LIST OF MATERIALS

ITEM NO.	MATERIAL
1	STEEL
2	STEEL

DRAWN J. SONAVANE CHECKED V. PATIL APPROVED R. RUTSCHILLING RELEASE DATE 2014-06-09 0098514-ECO RPS 38363 THIRD ANGLE PROJECTION	FLUID CONVEYANCE DIVISION DRAWING TITLE NIPPLE ASSEMBLY 90°, ORS FEMALE SWIVEL 2781 HOSE
SIZE A2 SCALE 3/1	DRAWING NUMBER ISA6FRB6 DIST U CAGE CODE 01276 SHEET 1
THE REPRODUCTION, DISTRIBUTION AND UTILIZATION OF THIS DOCUMENT, AS WELL AS THE COMMUNICATION OF ITS CONTENTS TO OTHERS WITHOUT EXPLICIT AUTHORIZATION IS PROHIBITED. OFFENDERS WILL BE HELD LIABLE FOR THE PAYMENT OF DAMAGES. ALL RIGHTS RESERVED IN THE EVENT OF THE GRANT OF A PATENT, UTILITY MODEL OR DESIGN. (PER ISO 18016)	

- ⑤ NIPPLE ALREADY BENT AND PLATED. DIMENSIONS ARE REFERENCE FOR ALREADY BENT AND PLATED NIPPLE.
 - ④ CRIMP NUT PER ES 2409PI.
 - ③ ZINC PLATE PER ES 2751D8. (M)
 - ② BEND NIPPLE TO DIMENSIONS SHOWN.
1. DIMENSIONS ARE IN MILLIMETERS [INCHES].