

THE REPRODUCTION, DISTRIBUTION AND UTILIZATION OF THIS DOCUMENT AS WELL AS THE COMMUNICATION OF ITS CONTENTS TO OTHER WITHOUT EXPLICIT AUTHORIZATION IS PROHIBITED. OFFENDERS WILL BE HELD LIABLE FOR THE PAYMENT OF DAMAGES. ALL RIGHT RESERVED IN THE EVENT OF THE GRANT OF A PATENT, UTILITY MODEL OR DESIGN. (PER ISO 10016)

REVISIONS			
REV	DESCRIPTION	DATE	APPROVED
F	REDRAWN - SUPERSEDES 1GA_FRA SHEET 1/2 REV."E" FOR 1GA24FRA24 (1)WAS 27.2±1.5 (2)WAS 113.4 REF	11-27-95	EN-F16101 DP-24900

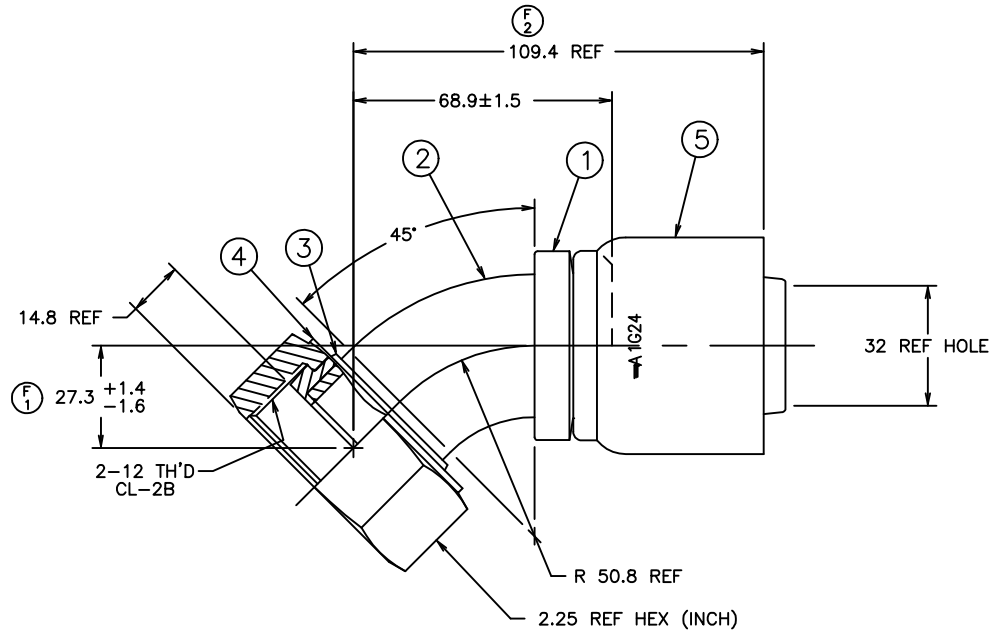

109.4	4.31
68.9±1.5	2.71±.06
50.8	2.00
32	1.26
27.3 +1.4/-1.6	1.07±.06
14.8	.58
MM	INCH

CONVERSION

METRIC

3. 1SA24FRA24 NIPPLE ASSEMBLY MAY BE SUBSTITUTED FOR ITEMS #1, #2, #3 AND #4.

△ CAN BE MADE FROM TUBING PER SPECIFICATIONS ON ELBOW DRAWING.

1. PROCESS AS FOLLOWS:
- ASSEMBLE NUT AND BRAZE PER ACES 2814.
 - ZINC PLATE PER ACES 2751.
 - ASSEMBLE SOCKET PER ACES 2813.

1GA24FRA24	1F40014-2424AB	FC1385-24S	FC1229-2424S	FC1857-24-186	1G24
AEROQUIP PART NUMBER	① NIPPLE	② ELBOW △	③ SHOULDER	④ NUT	⑤ SOCKET
LIST OF MATERIALS					
ITEM NO.	MATERIAL	DRAWN M.MOLINA			
1	STEEL	CHECKED R.D.GARRETT			
2	STEEL	APPROVED R.D.GARRETT			
3	STEEL	RELEASE DATE 11-27-95			
4	STEEL	EN-F16101 DP-24900			
5	STEEL	THIRD ANGLE PROJECTION			
		DRAWING TITLE		REV	
		FITTING ASSEMBLY		F	
		45°, ORS FEMALE SWIVEL, OTC			
		SIZE C	DRAWING NUMBER 1GA24FRA24		
		SCALE 1/1	DIST U	CAGE CODE 01276	SHEET NO

Dauphin FLUID CONVEYANCE DIVISION

CONVERTED DRAWING CADAM to AutoCAD 8/98

DWG. NO. 1GA24FRA24 SH. REV. F