

THE REPRODUCTION, DISTRIBUTION AND UTILIZATION OF THIS DOCUMENT AS WELL AS THE COMMUNICATION OF ITS CONTENTS TO OTHERS WITHOUT EXPLICIT AUTHORIZATION IS PROHIBITED. OFFENDERS WILL BE HELD LIABLE FOR THE PAYMENT OF DAMAGES. ALL RIGHT RESERVED IN THE EVENT OF THE GRANT OF A PATENT, UTILITY MODEL OR DESIGN. (PER ISO 15018)

REVISIONS

REV	DESCRIPTION	DATE	APPROVED
A	REDRAWN - SUPERSEDES 1GA_FJC_ REV. "NONE" FOR 1GA20FJC20 (1) NOTE #1(c) WAS: "CRIMP NUT PER ACES 2409P2"	1-3-96	EN-F16132 DP-24900

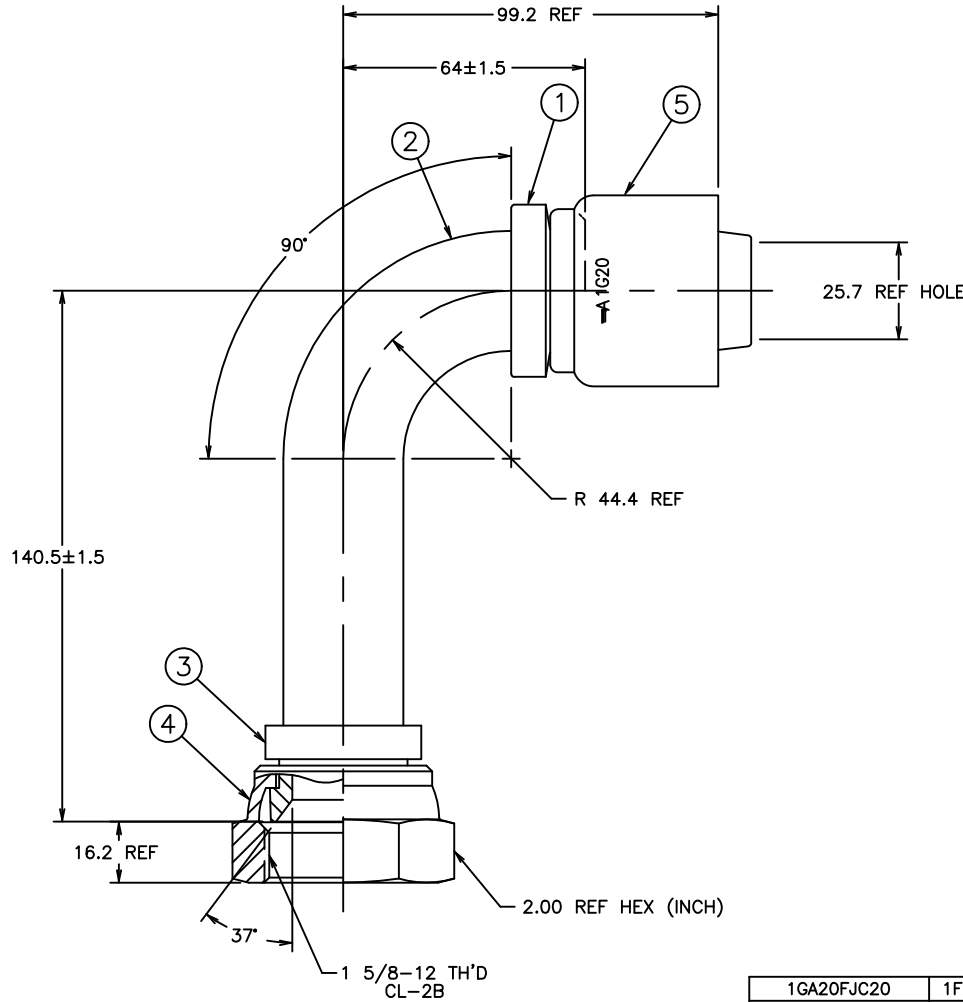

140.5±1.5	5.53±.06
99.2	3.91
64±1.5	2.52±.06
44.4	1.75
25.7	1.01
16.2	.64
MM	INCH

CONVERSION

METRIC

1GA20FJC20	1F40014-2020AB	FC2961-20S	FC2775-2020S	210204-20S	1G20
AEROQUIP PART NUMBER	① NIPPLE	② ELBOW	③ SHOULDER	④ NUT	⑤ SOCKET
LIST OF MATERIALS					
ITEM NO.	MATERIAL	DRAWN M.MOLINA			
1	STEEL	CHECKED R.GARRETT			
2	STEEL	APPROVED R.GARRETT			
3	STEEL	RELEASE DATE 1-4-96			
4	STEEL	EN-F16132 DP-24900			
5	STEEL	THIRD ANGLE PROJECTION			
		SIZE C	DRAWING NUMBER 1GA20FJC20	REV A	
		SCALE 1/1	DIST U	CAGE CODE 01276	SHEET NO

- △ CAN BE MADE FROM TUBING PER SPECIFICATIONS ON ELBOW DRAWING.
2. 1SA20FJC20 NIPPLE ASSEMBLY MAY BE SUBSTITUTED FOR ITEMS #1, #2, #3 AND #4.
1. PROCESS AS FOLLOWS:
- BRAZE PER ACES 2814.
 - ZINC PLATE PER ACES 2751.
 - CRIMP NUT PER ACES 2813.
 - ASSEMBLE SOCKET PER ACES 2813.

①

REV. A
SH. A
1GA20FJC20
DWG. NO.

CONVERTED DRAWING | CADAM to AutoCAD | 8/98