

DISPLACEMENT CODE	G MAX	DISPLACEMENT CODE	G MAX
022	133.4 [5.25]	179	167.5 [6.59]
025	134.2 [5.29]	226	177.9 [7.00]
028	133.4 [5.25]	451	228.7 [9.01]
035	137.2 [5.40]		
045	137.2 [5.40]		
059	140.3 [5.52]		
073	143.6 [5.65]		
089	147.1 [5.79]		
097	149.0 [5.87]		
113	152.5 [6.00]		
141	158.8 [6.25]		

REV	DESCRIPTION	BY	DATE	ECN
A	ENGINEERING RELEASE	RAF	2-23-94	M11296
B	(4B)Ø13.59+0.38/-0.13 [5.35+0.015/-0.005] WAS Ø13.59±0.13 [5.35±0.005]	AGJ	1-28-02	39853
C	-1)X(4C)WAS 131.4/[5.17]MAX -2)X(4B)WAS 96.8/[3.81]MAX	SJP	04-07-04	46856
D	-1)REVISED PICTORIALY -2)X(4D)UPDATED TABULATION FOR G MAX -3)X(2B)REMOVED DIM 5.1[.20] MAX -4)UPDATED NOTE AS PER ESP-022-69	AAB	02-17-14	0055528
E	(1C)ADDED EATON LOGO TO END CAP	AAB	01-22-15	0061684
F	(3A) NOTE 3 WAS CASE DRAIN : 2...	JVD	07-27-15	0065202

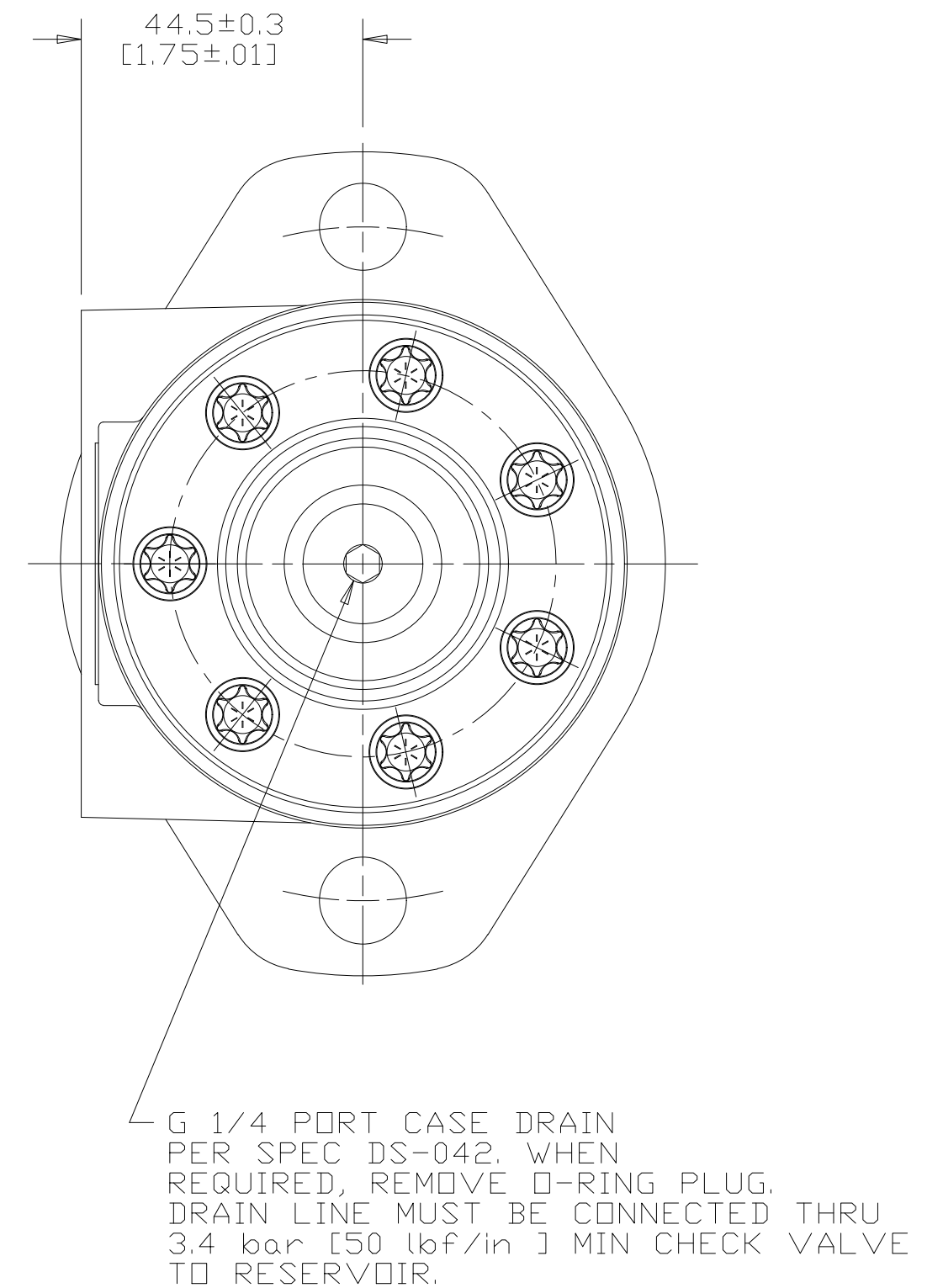
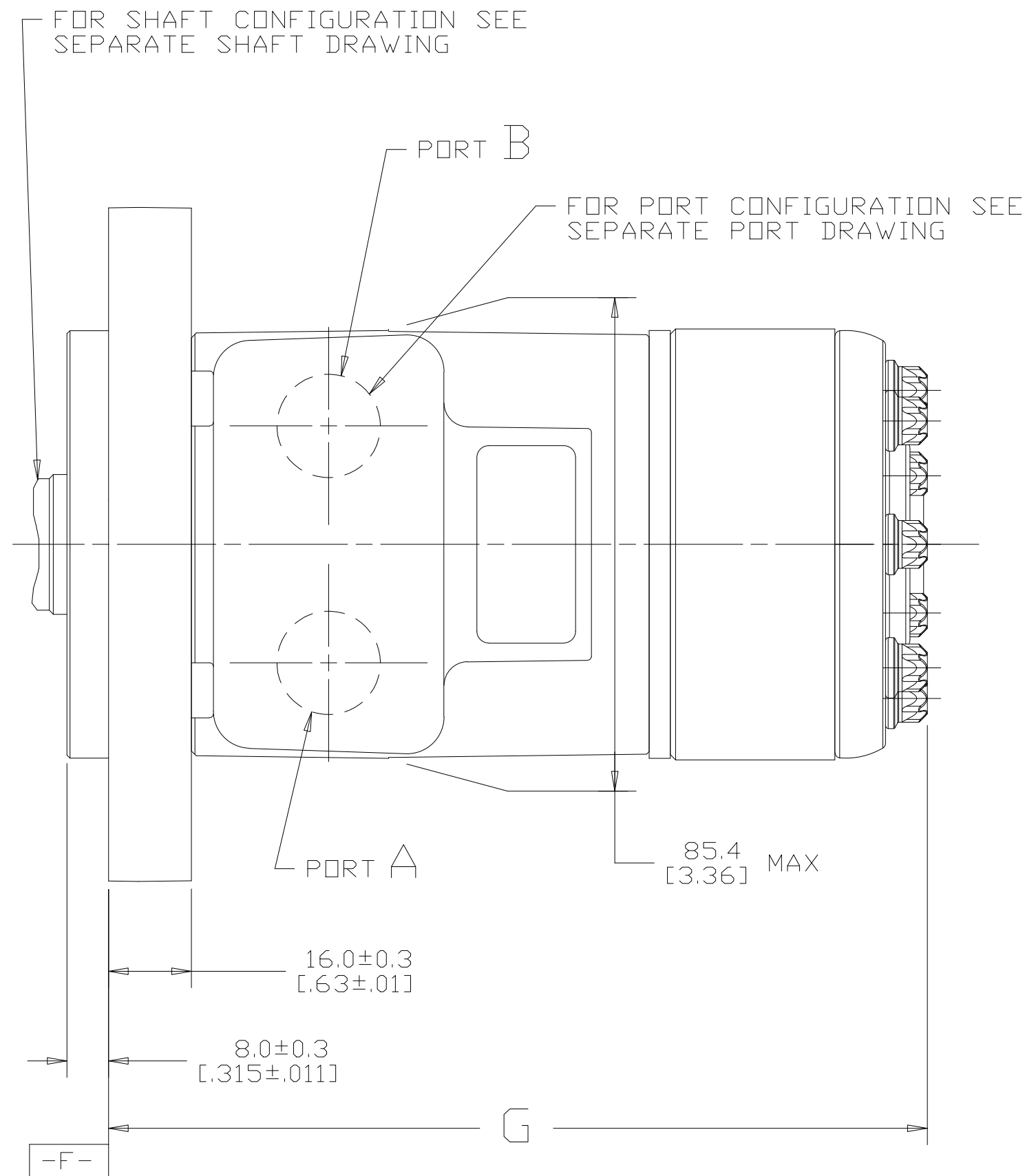
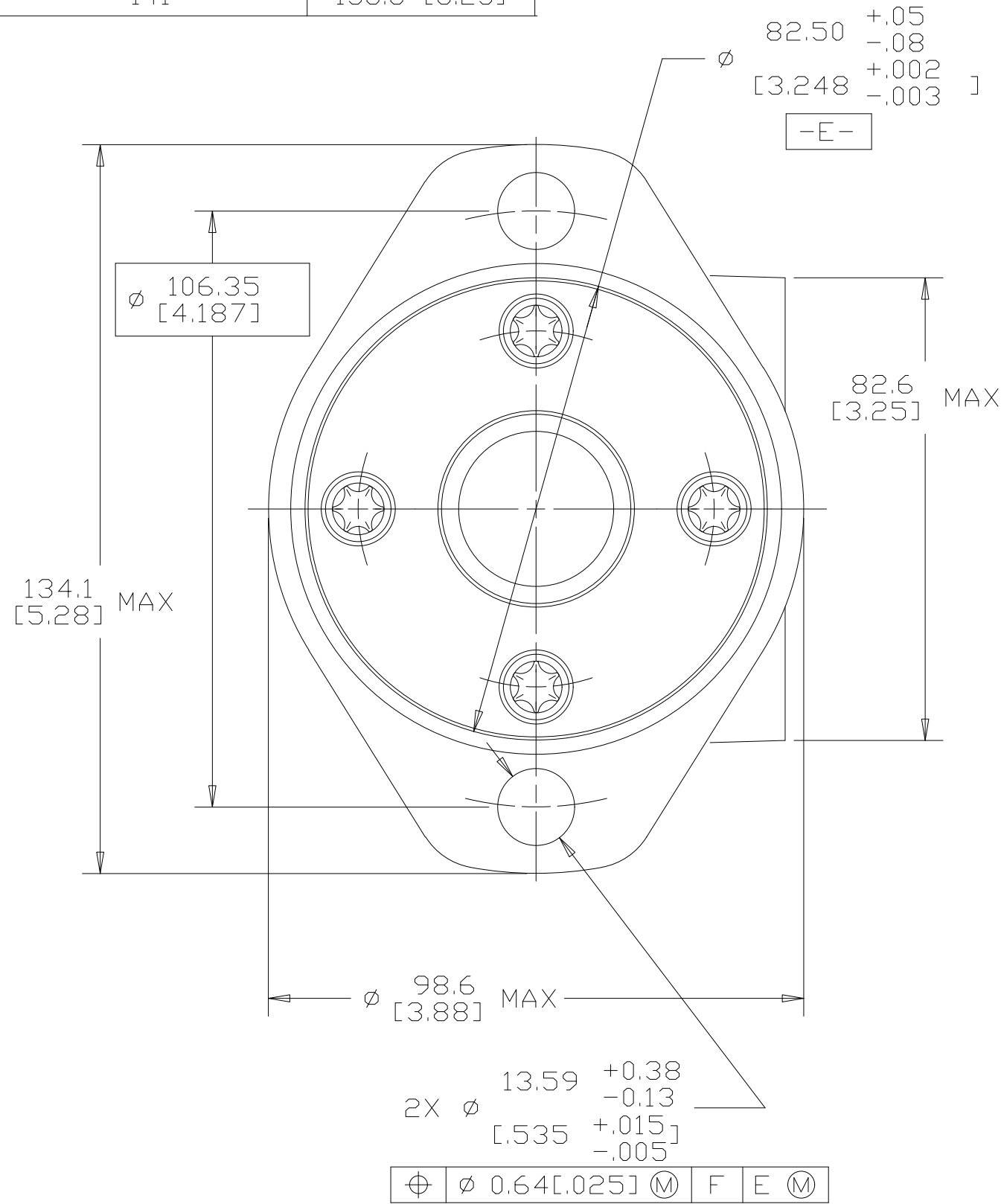

NOTE:

- 1 ROTATION:
STANDARD: WHEN FACING SHAFT END OF MOTOR SHAFT TO ROTATE CLOCKWISE WHEN PORT "A" IS PRESSURIZED COUNTERCLOCKWISE WHEN PORT "B" IS PRESSURIZED

REVERSE : WHEN FACING SHAFT END OF MOTOR SHAFT TO ROTATE CLOCKWISE WHEN PORT "B" IS PRESSURIZED COUNTERCLOCKWISE WHEN PORT "A" IS PRESSURIZED
- 2 MOUNTING FLANGE:
MA = 2 BOLT STD: Ø82.50 [3.248] X 8.13 [3.20] PILOT
Ø 13.59[5.35] MOUNTING HOLES ON Ø106.35 [4.187] B.C.
- 3 CASE DRAIN:
02 = G 1/4 PORT (END CAP)

REVIEWED FOR CLASSIFICATION PER ESP-042

UNLESS OTHERWISE SPECIFIED ALL DIMENSIONS ARE IN		DRAWING BASED ON ANSI Y14.5M-1982	
INCHES <input type="checkbox"/>	MILLIMETERS <input checked="" type="checkbox"/>	THE REPRODUCTION, DISTRIBUTION AND UTILIZATION OF THIS DOCUMENT AS WELL AS THE COMMUNICATION OF ITS CONTENTS TO OTHER WITHOUT EXPLICIT AUTHORIZATION IS PROHIBITED. OFFENDERS WILL BE HELD LIABLE FOR THE PAYMENT OF DAMAGES. ALL RIGHT RESERVED IN THE EVENT OF THE GRANT OF A PATENT, UTILITY MODEL OR DESIGN. (PER ISO 16016)	
TOLERANCES			
x ± ----	.xx ± ----		
.xxx ± ----	< ± ----	DRAWN BY/DATE RAF 3/1/94	MATERIAL/HEAT TREAT
UNSPECIFIED RADII ARE		CHECKED BY/DATE SDR 3/2/94	TITLE
-----		ENGRG BY/DATE RVA 3/3/94	H MOTOR INSTALLATION
UNSPECIFIED DRAFT ANGLES ARE		METALLURGY BY/DATE	MICROINCHES <input type="checkbox"/> NUMBER
-----		THIRD ANGLE PROJECTION	MICROMETERS <input type="checkbox"/>
DRAWING FORMAT CADD <input checked="" type="checkbox"/> MANUAL <input type="checkbox"/>		DO NOT SCALE	ARITHMETICAL AVERAGE <input checked="" type="checkbox"/>
		SCALE 1/1	SHEET 1 OF 1

A-37-049